



SINCE 1998

SMARTER LIGHTING CHOICES

SINCE 1998





SMART HOME CONTROLS

An innovative range of Smart Home controls with Bluetooth & WIFI connectivity.



SAL PIXIE & PIXIE PLUS products can save the installer time when creating multi-switch control lighting circuits by using the innovative SAL PIXIE Multifunction control or the SAL PIXIE Multifunction remote control. Check out the wiring diagrams of the SAL PIXIE Multifunction controls to see how simple it is to save time and money with multifunction switch circuits.



SAL PIXIE, AN AFFORDABLE CHOICE FOR SMART HOME AUTOMATION.

PIXIE devices are a versatile range of digital Smart Home controls that are designed for easy installation by an electrician and simple operation by the consumer, whether it be as a standard digital switch or dimmer or utilising the smarts of Bluetooth Mesh Technology.

PIXIE PLUS is an affordable choice for home automation, where with the internet and the **PIXIE** Gateway, you can control your **PIXIE** control devices from anywhere in the world.

The
PIXIE PLUS app,
is smart enough
to control multiple
HOME locations,
work or play!



Device
Manage devices,
individual control



Group
Simultaneously
control a group
of up to 32 x PIXIE
devices



Schedule
Schedule your
lights



Scene
Create preset
lighting scenes



Timer
Countdown
turn-off timer



Sync
PIXIE RGB strips
flash to music

**PIXIE PLUS is compatible with
popular voice control devices.**



SmartThings



works with the
Google Assistant

**Siri &
Amazon
Alexa.**

PIXIE - WHICH PRODUCT DO I NEED?

The choice is easy, PIXIE products consist of a **MASTER** device which are designed to operate as a stand alone electrical device AND **SECONDARY** devices which are designed to operate with a paired **MASTER** PIXIE device, providing equal functionality to the connected master device.





PIXIE SMART DIMMER SDD350BT G2

SMART HOME push button dimmer, Generation 2

Application

Smart digital lighting control with Bluetooth Mesh Technology for residential and commercial spaces

Design Specifications

- Digital push button control, with three (3) complimentary key caps provided to suit most switch plates
- When used as a digital device, push on/off, hold to dim up or down, memory function, selectable minimum dim level
- When used with the SAL PIXIE or PIXIE PLUS app, set a scene, group devices, set a schedule, dim, switch, set a timer
- With the inclusion of the SAL PIXIE Gateway and the internet, you can control your PIXIE devices from anywhere in the world
- Overheating, overload and full short circuit protection, maximum load 350 watt, minimum load 2 watt
- SMART LED indicator, Trailing edge phase cutting dimming, Fits most branded switch plates. 1, 2 or 3 gang
- Complies to AS/NZS 60669.2.1, typical wireless range 15 metres



Wiring Diagram

SDD350BT G2 - Standard wiring diagram

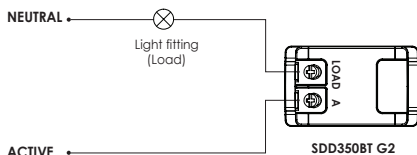

SDD350BT G2 - Optional wiring diagram

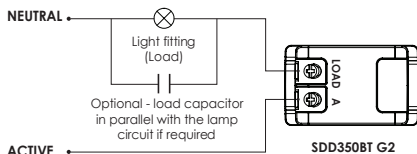

Technical Specifications

Model No.	Input (V)/(Hz)	Min./Max. loads	Colour	Dimension (L x W x H mm)	Dimming Technique	Wireless
SDD350BT	240/50	2W*/350W	White	40 x 24 x 38	Trailing edge	Bluetooth Mesh Technology

*Subject to product capability, this size load may require the inclusion of the LOAD capacitor included in the product carton.

For terms and conditions of catalogue data use, refer to INDEX



PIXIE SMART SWITCH SWL350BT G2

SMART HOME push button switch, Generation 2

Application

Smart digital lighting control with Bluetooth Mesh Technology for residential and commercial spaces

Design Specifications

- Digital push button control with three (3) complimentary key caps provided to suit most switch plates
- Smaller design profile and easier to install with large wiring terminals
- Operating the device with the PIXIE or PIXIE PLUS app allows the user to set a scene, group devices, set a schedule, set a timer and more!
- With the inclusion of the SAL PIXIE Gateway and the internet, you can control your PIXIE devices from anywhere in the world
- Overheating, overload and full short circuit protection, maximum load 350 watt, minimum load 13 watt. For load type compatibility, please refer to installation instructions.
- SMART LED indicator, Fits most branded switch plates. 1, 2 or 3 gang
- Complies to AS/NZS 60669.2.1, typical wireless range 15 metres



Wiring Diagram

SWL350BT G2 - Standard wiring diagram

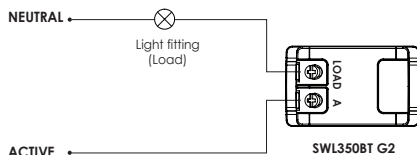

SWL350BT G2 - Optional wiring diagram

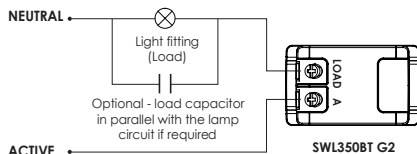

Technical Specifications

Model No.	Input (V)/(Hz)	Min./Max. loads	Colour	Dimension (L x W x H mm)	Wireless
SWL350BT	240/50	13W*/350W	White	40 x 24 x 38	Bluetooth Mesh Technology

*Subject to product capability, this size load may require the inclusion of the LOAD capacitor included in the product carton.

For terms and conditions of catalogue data use, refer to INDEX





PIXIE MASTER

PIXIE TIMER SWITCH STS350BT

SMART HOME digital push button timer switch from 1 minute to 24 hour

Application

Ideal for residential designs and commercial interior spaces requiring precise digital scheduling and energy saving opportunities

Design Specifications

- Digital push button control with three (3) complimentary key caps provided to suit most switch plates
- Easy to install, (1) minute to (24) hour programmable delay time
- Easy navigation and simple time delay selection when using the app.
- As a PIXIE MASTER device, functionality is achieved with all compatible loads, see installation sheet for details
- With the inclusion of the SAL Gateway and the internet, you can control your PIXIE devices from anywhere in the world
- Support override function and restart delay timer functions



Wiring Diagram

STS350BT - Standard wiring diagram

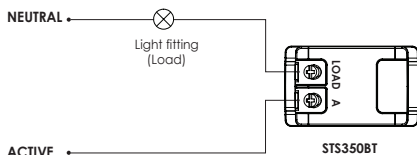

STS350BT - Optional wiring diagram

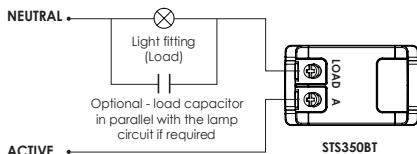

Technical Specifications

Model No.	Input (V)/(Hz)	Min./Max. loads	Colour	Dimension (L x W x H mm)	Wireless
STS350BT	240/50	13W*/350W	White	40 x 24 x 38	Bluetooth Mesh Technology

*Subject to product capability, this size load may require the inclusion of the LOAD capacitor included in the product carton.

For terms and conditions of catalogue data use, refer to INDEX

CONTROL YOUR LIGHTING FROM ANYWHERE IN THE WORLD



PMAS
SMARTASSAI
PXIE
PLUS

PIXIE MASTER

PIXIE SMART SWITCH SWL600BTAM G3

SMART HOME - digital 600 watt Bluetooth Mesh
Technology push button switch

Application

Smart lighting controls with Bluetooth Mesh
connectivity for residential and commercial spaces

Design Specifications

- Easy two wire termination with fly lead termination, compliant to AS/NZS 60669.2.1 and designed with a typical wireless range of 15 metres, or further with the SAL USB signal booster.
- Digital push button control with three (3) complimentary key caps provided to suit most switch plates
- Operating the device with the SAL PIXIE app allows the user to set a scene, group devices, set a schedule, set a timer and more!
- Fully compatible with PIXIE PLUS, so with the inclusion of the SAL Gateway and the internet, you can control your PIXIE devices from anywhere in the world, or with compatible voice control devices.
- Overheating, overload and full short circuit protection, maximum load 600 watt, minimum load 9 watt. For load type compatibility, including exhaust fans, please refer to installation instructions.
- SMART LED indicator, versatile design, fitting most branded switch plates, 1 - 6 gang configurations.



Wiring Diagram

SWL600BTAM - Standard wiring diagram

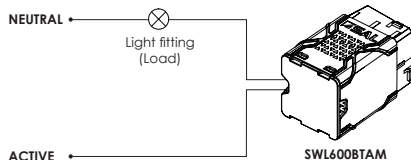

SWL600BTAM - Optional wiring diagram

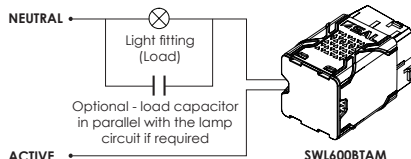

Technical Specifications

Model No.	Description	Input (V)/(Hz)	Min./Max. loads	Dimension (L x W x H mm)	Wireless
SWL600BTAM	PIXIE SMART SWITCH 600W	240/50	9W*/600W	42 x 24 x 24	Bluetooth Mesh Technology

*Subject to product capability, this size load may require the inclusion of the LOAD capacitor included in the product carton.

For terms and conditions of catalogue data use, refer to INDEX



PIXIE MASTER

PIXIE SMART SWITCH SWL600BTAM/BP G3

SMART HOME - digital 600 watt Bluetooth Mesh Technology push button switch, with Bell Press functions

Application

Smart lighting controls with Bluetooth Mesh connectivity for residential and commercial spaces

Design Specifications

- SWL600BTAM/BP includes Bell Press termination leads for dry contact signal input.
- Easy two wire termination with fly lead termination, compliant to AS/NZS 60669.2.1 and designed with a typical wireless range of 15 metres, or further with the SAL USB signal booster.
- Digital push button control with three (3) complimentary key caps provided to suit most switch plates.
- Operating the device with the SAL PIXIE app allows the user to set a scene, group devices, set a schedule and more!
- Fully compatible with PIXIE PLUS, so with the inclusion of the SAL Gateway and the internet, you can control your PIXIE devices from anywhere in the world, or with compatible voice control devices.
- Overheating, overload and full short circuit protection, maximum load 600 watt, minimum load 9 watt. For load type compatibility, including exhaust fans, please refer to installation instructions.
- SMART LED indicator, versatile design, fitting most branded switch plates, 1 - 6 gang configurations.



Wiring Diagram

SWL600BTAM/BP - Standard wiring diagram

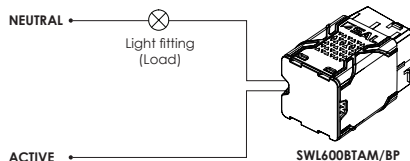

SWL600BTAM/BP - Optional wiring diagram

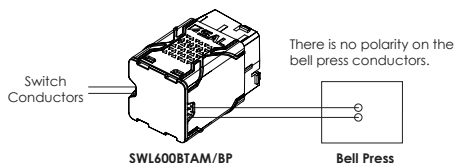

Technical Specifications

Model No.	Description	Input (V)/(Hz)	Min./Max. loads	Dimension (L x W x H mm)	Wireless
SWL600BTAM/BP	PIXIE SMART SWITCH 600W	240/50	9W*/600W	42 x 24 x 24	Bluetooth Mesh Technology

*Subject to product capability, this size load may require the inclusion of the LOAD capacitor included in the product carton.

For terms and conditions of catalogue data use, refer to INDEX





PIXIE SECONDARY

PIXIE MULTIFUNCTION CONTROL SMF/BTAS G3

SMART HOME digital push button multifunction control

Application

Ideal for residential designs, commercial interior spaces requiring multiple location device control

Design Specifications

- Digital push button control to enable multi-way switching or dimming control, group control or scene activation, simply with an active and neutral termination. All devices must be paired once installed, for functionality.
- Three (3) complimentary key caps provided to suit most switch plates
- Easy to install, dim and switch with ease, two wire termination mech.
- Switch or dimming control is achieved only in conjunction with PIXIE Master controls.
- Fully compatible with PIXIE and PIXIE PLUS
- Slimline design to allow 1-6 gang configurations



Wiring Diagram

Active

240V/50Hz AC

Neutral

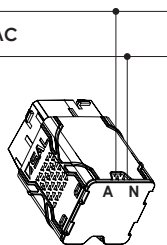

SMF/BTAS



Technical Specifications

Model No.	Description	Input (V)/(Hz)	Dimension (L x W x H mm)	Wireless
SMF/BTAS	PIXIE SMART MULTIFUNCTION CONTROL	240/50	42 x 24 x 24	Bluetooth Mesh Technology

*Subject to product capability, this size load may require the inclusion of the LOAD capacitor included in the product carton.

For terms and conditions of catalogue data use, refer to INDEX



PIXIE SECONDARY

PIXIE MULTIFUNCTION CONTROL SMF/BTAS/BP G3

SMART HOME digital push button multifunction control, with Bell Press functions

Application

Ideal for residential designs, commercial interior spaces requiring multiple location device control

Design Specifications

- SMF/BTAS/BP includes Bell Press termination leads for dry signal input.
- Digital push button control to enable multi-way switching or dimming control, group control or scene activation, simply with an active and neutral termination. All devices must be paired once installed, for functionality.
- Three (3) complimentary key caps provided to suit most switch plates.
- Easy to install, dim and switch with ease, two wire termination.
- Switch or dimming control is achieved only in conjunction with PIXIE smart Master devices
- Fully compatible with PIXIE and PIXIE PLUS
- Slimline design to allow 1-6 gang configurations



Wiring Diagram

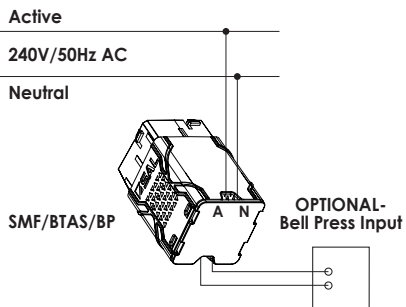

There is no polarity on the bell press conductors.



Technical Specifications

Model No.	Description	Input (V)/(Hz)	Dimension (L x W x H mm)	Wireless
SMF/BTAS/BP	PIXIE SMART MULTIFUNCTION CONTROL	240/50	42 x 24 x 24	Bluetooth Mesh Technology

*Subject to product capability, this size load may require the inclusion of the LOAD capacitor included in the product carton.

For terms and conditions of catalogue data use, refer to INDEX





PIXIE SECONDARY

PIXIE MULTI-WAY SWITCH S2W/BT

SMART HOME digital push button 2 way or 3 way switch or dimming control

Application

Ideal for residential designs, commercial interior spaces requiring multiple location device control

Design Specifications

- Digital remote push button control to enable 2 way or 3 way switch or dimming control,
- Three (3) complimentary key caps provided to suit most switch plates
- Complies to AS/NZS 60669.2.1, easy to retrofit Dim or switch with ease, with no messy additional wiring circuits required. Two wire termination mech.
- Switch or dimming control is achieved only in conjunction with PIXIE smart switch (SWL350BT) or PIXIE smart dimmer (SDD350BT). All devices must be paired once installed, for functionality.
- Fully compatible with the PIXIE app and PIXIE PLUS app



Dimensions

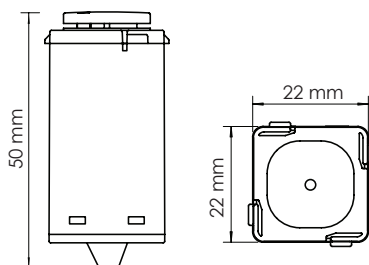

Technical Specifications

Model No.	Input (V)/(Hz)	Colour	Dimension (L x W x H mm)	Wireless
S2W/BT	240/50	White	50 x 22 x 22	Bluetooth Mesh Technology

For terms and conditions of catalogue data use, refer to INDEX

Wiring Diagram

Fig. 1: Replacing an existing two-way switching with PIXIE two-way dimming / switching

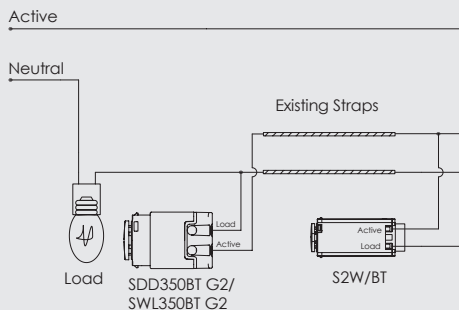

Fig. 1A: PIXIE new installation two-way dimming / switching

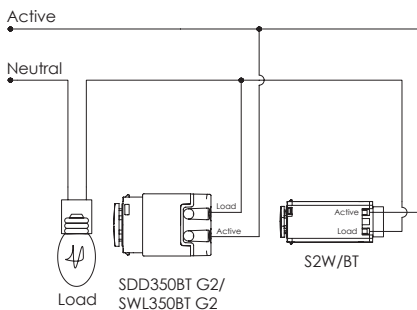

Fig. 2: Replacing an existing three-way switching with PIXIE three-way dimming / switching

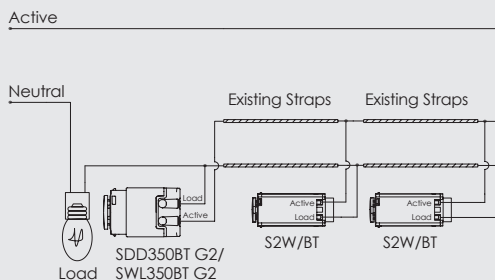
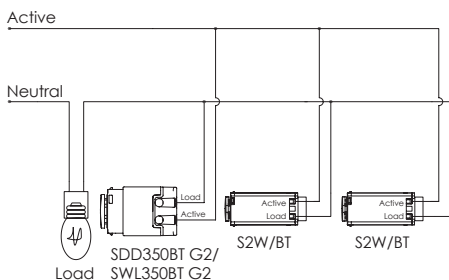

Fig. 2A: PIXIE new installation three-way dimming / switching circuit



PIXIE SECONDARY

PIXIE MULTIFUNCTION REMOTE CONTROL SMC/BT

SMART HOME battery powered push button remote control

Application

Ideal for residential designs, care homes where access to switches is difficult or restricted for the user and installations where additional wiring requirements is unrealistic

Design Specifications

- Digital remote push button control with connectivity to any PIXIE device within 15 metres
- Simple, remote battery control with a blue LED function indicator
- Dim, switch with ease, no messy wiring
- Switch or dimming control is achieved only in conjunction with equivalent PIXIE devices or products. All devices must be paired for functionality.
- Standard colour - WHITE, ϕ 45mm x 14mm, **order code SMC/BT** and don't forget about the very stylish covers **SRC/BTP** shown, which are ordered separately and are packed in sets of three (3)



Technical Specifications

Model No.	Input (V DC)	Colour	Dimension (D x H mm)	Wireless
SMC/BT	6	White	\varnothing 45 x 14	Bluetooth Mesh Technology
SRC/BTP		White & Red & Grey	

For terms and conditions of catalogue data use, refer to INDEX

PIXIE WITH BLUETOOTH MESH TECHNOLOGY





PIXIE SECONDARY

PIXIE TIMER CONTROL STC/BT

SMART HOME push button timer delay control from 1 minute to 24 hours

Application

Ideal for residential designs and commercial interior spaces requiring precise digital scheduling

Design Specifications

- Digital push button control
- Three (3) complimentary key caps provided to suit most switch plates
- Easy to install, (1) minute to (24) hour programmable delay time
- PIXIE and PIXIE PLUS app enabled for easy navigation and time selection
- Functionality is achieved only with SAL PIXIE Master devices
- Fully compatible with PIXIE or PIXIE PLUS



**1 MINUTE-
24 HOUR
CONTROL**



Technical Specifications

Model No.	Input (V)/(Hz)	Colour	Dimension (L x W x H mm)	Wireless
STC/BT	240/50	White	50 x 22 x 22	Bluetooth Mesh Technology

For terms and conditions of catalogue data use, refer to INDEX



PIXIE SECONDARY

PIXIE USB SIGNAL BOOSTER SGB/BT

SMART HOME PIXIE USB signal booster designed to extend the PIXIE control network

Application

Ideal for installations where the wireless signal strength is limited



Design Specifications

- The PIXIE Signal Booster is a USB powered device that can plug into a standard USB port
- The device is designed to expand the signal coverage of the PIXIE network, maintaining a consistent wireless signal within the PIXIE system
- Maximum distance between any PIXIE device is ideally 15 metres, with a maximum of 10 x SGB/BT devices per PIXIE HOME
- Switch or dimming control is achieved only in conjunction with PIXIE devices or products
- The SGB/BT LED indicator can be turned off if required. To turn off the LED indicator: Quickly click the button 7 times to totally turn off LED indicator



Quick installation Instructions

1. **ESTABLISH A HOME FOR THE BOOSTER**
– Select a position within the installation, where the signal booster can be located centrally and no further than 15 metres from a PIXIE device.
2. **INSTALLATION** – Insert the Signal Booster into standard USB port (DC 5V 1A), initially the LED indicator is in white colour.
3. **PAIR THE BOOSTER** – Open the PIXIE app via your smart phone device, then select "Device" -> "Add device", which will then search for the signal booster. Once identified add it into the app and when the LED indicator on signal booster turns blue, it is paired.

Technical Specifications

Model No.	Input (V)/(Hz)	Colour	Dimension (L x W x H mm)	Wireless
SGB/BT	240/50	Black	70 x 23 x 10	Bluetooth Mesh Technology

For terms and conditions of catalogue data use, refer to INDEX



SAL **PIXIE** PLUS CONTROL YOUR HOME LIGHTING FROM ANYWHERE IN THE WORLD





PIXIE MASTER

PIXIE GATEWAY SGW/BT

SMART HOME PIXIE Gateway - control
your PIXIE devices from anywhere in the world

Application

An affordable choice in home or office
lighting automation with WIFI connectivity

Design Specifications

- Simple plug and play design, controlling up to 32 x PIXIE devices per gateway
- Compatible with popular voice control devices, such as Google Home and Amazon Alexa
- The PIXIE Gateway is supported by a FREE app for easy navigation - PIXIE PLUS
- The PIXIE PLUS app is compatible with all SAL PIXIE products
- Switch, dim, schedule, group, set a timer, set a scene, sync your PIXIE led strips to music and more with PIXIE PLUS.
- Need more help in navigation? Check out the HELP page on the PIXIE PLUS app or visit YouTube for the PIXIE PLUS introduction video



Dimensions

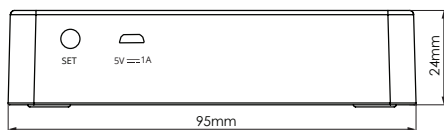

Technical Specifications

Model No.	Input (V)/(Hz)	Colour	Dimension (L x W x H mm)	Wireless
SGW/BT	240/50	Black	95 x 95 x 24	Bluetooth Mesh Technology

For terms and conditions of catalogue data use, refer to INDEX



PIXIE PLUS is an affordable choice for home lighting automation, where you can control your lighting from anywhere in the world.

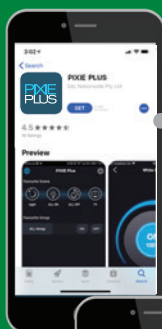

Step 1. Scan the QR code below and download the SAL PIXIE PLUS app to your smart phone or tablet.

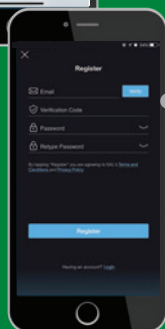

Step 2. Launch the app and register your PIXIE PLUS account.



Step 3. Create a HOME, then connect and discover the PIXIE GATEWAY device. Once you configure your time zone and pair your WiFi router, you are ready to add your controllable PIXIE devices.

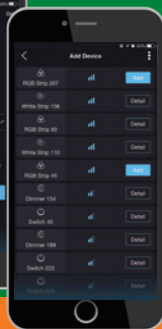
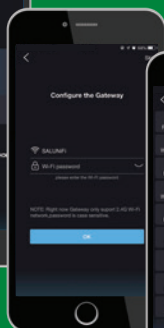



PIXIE PLUS is easy to operate and allows the user to control a comprehensive selection of lighting commands; set a scene, set a schedule, dim, switch, group devices, sync your lights to music and more! After the simple installation of the PIXIE Gateway and the PIXIE PLUS app, you can control your PIXIE Smart Home devices via the internet, or voice control with the addition of a popular voice control device.

For ease of connectivity, the free SAL PIXIE PLUS app is available from the App store in iOS and Google Play Android platforms. PIXIE digital switches, multifunction controls and dimming devices comply with AS/NZS 60669.2.1 and are designed to fit most common branded single, double or triple switch plates and are provided with a set of complimentary shaped key caps.



Need more information? **Select any of the PIXIE videos found** **on sal.net.au or YouTube**



PIXIE Introduction



PIXIE Switch & Dimmer



PIXIE Multiway Switch



PIXIE Multifunction Control/Remote Control

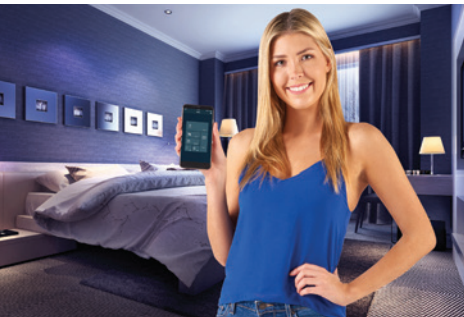

PIXIE app



PIXIE PLUS app



PIXIE MASTER

PORTABLE SMART PLUG ESS105/BT

SMART HOME Australian approved portable three pin 240V, 6A smart plug

Application

Portable surface plug,
ideal for the office or home

Design Specifications

- Australian approved three pin portable 240V, 6A 1500 watt plug, compliant to AS/NZS 3105:2014, AS/NZS 60950.1:2015
- Integral USB port, 5V DC, 1.5A
- Bluetooth Mesh Technology, control your device with PIXIE or PIXIE PLUS
- Durable polycarbonate construction
- Colour white, compact, low profile design
- Plug output and USB port can be controlled separately
- Programmable schedules for both the plug output and USB port with PIXIE

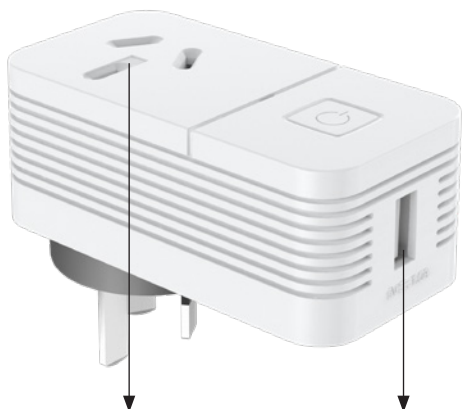

Smart Plug Output
240V 6A

Smart USB output
5V 1.5A

Dimensions

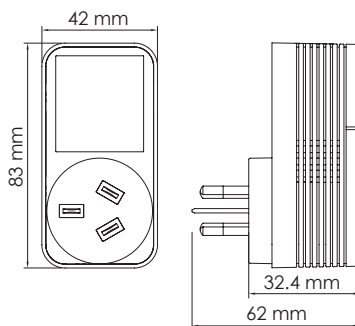

Technical Specifications

Model No.	Input (V)/(Hz)	Max. Loads	Dimensions (L x W x H mm)	Type
ESS105/BT	240/50	6A	82 x 62 x 42	Portable, three pin, USB



PIXIE AMBIENCE GPO SMART SOCKET SPO23/BTAM

SMART HOME - Australian approved, fixed 250V / 10A
Smart double socket with multifunction control

Application

Ideal for the home or office, Bluetooth connectivity, with multifunction control

Design Specifications

- Australian approved three pin fixed 250V, 10A socket, compliant to AS/NZS 3112:2017
- Integral multifunction control
- Bluetooth Mesh Technology, control your device with full functions of PIXIE, PIXIE PLUS and compatible voice control devices with the installation of the SAL PIXIE gateway
- Durable polycarbonate construction, colour white, compact low profile design
- Programmable schedules with PIXIE or PIXIE PLUS
- Child lock functions for added safety
- Power monitoring function with PIXIE PLUS

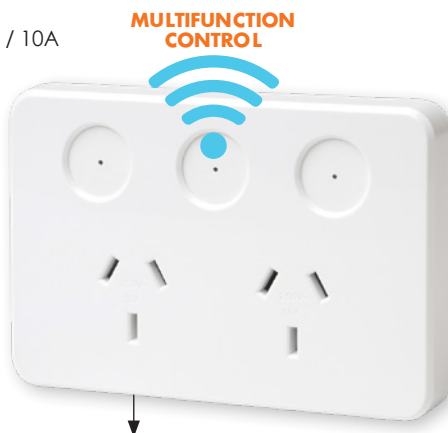

Smart Socket
Output 250V 10A

Dimensions

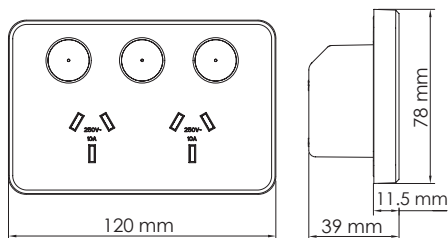

Technical Specifications

Model No.	Description
SPO23/BTAM	PIXIE Ambience Socket 10A White
SPO23AB/BTP	PIXIE Ambience cover/A/Black
SPO23AG/BTP	PIXIE Ambience cover/A/Grey

Model No.	Description
SPO23CW/BTP	PIXIE Ambience cover/C/White
SPO23EW/BTP	PIXIE Ambience cover/E/White
SPO23IW/BTP	PIXIE Ambience cover/I/White

For terms and conditions of catalogue data use, refer to INDEX



PIXIE AMBIENCE, CHANGE YOUR STYLE.



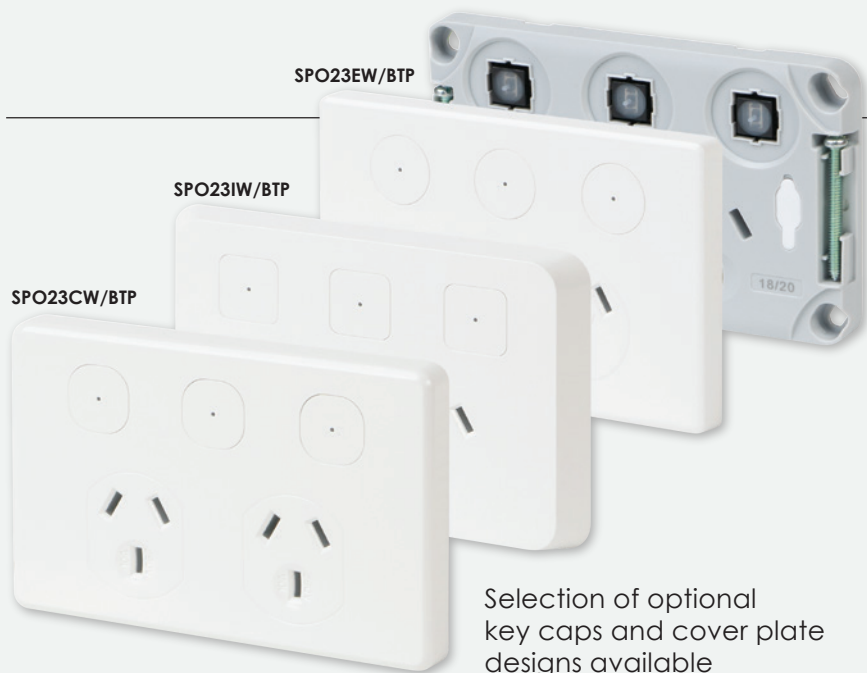

PIXIE AMBIENCE, CHANGE YOUR **STYLE.**

The innovative PIXIE AMBIENCE SMART GPO has been designed with the end user and installer in mind, allowing you to change the style or the colour face plate as fashion demands.

In addition to the standard 250V, 10A capacity, the AMBIENCE SMART double GPO includes an innovative PIXIE Multifunction control, which when paired with another PIXIE Master device, you can enable multi-way switching or dimming control, group control or scene activation.

PIXIE
Multifunction
Control

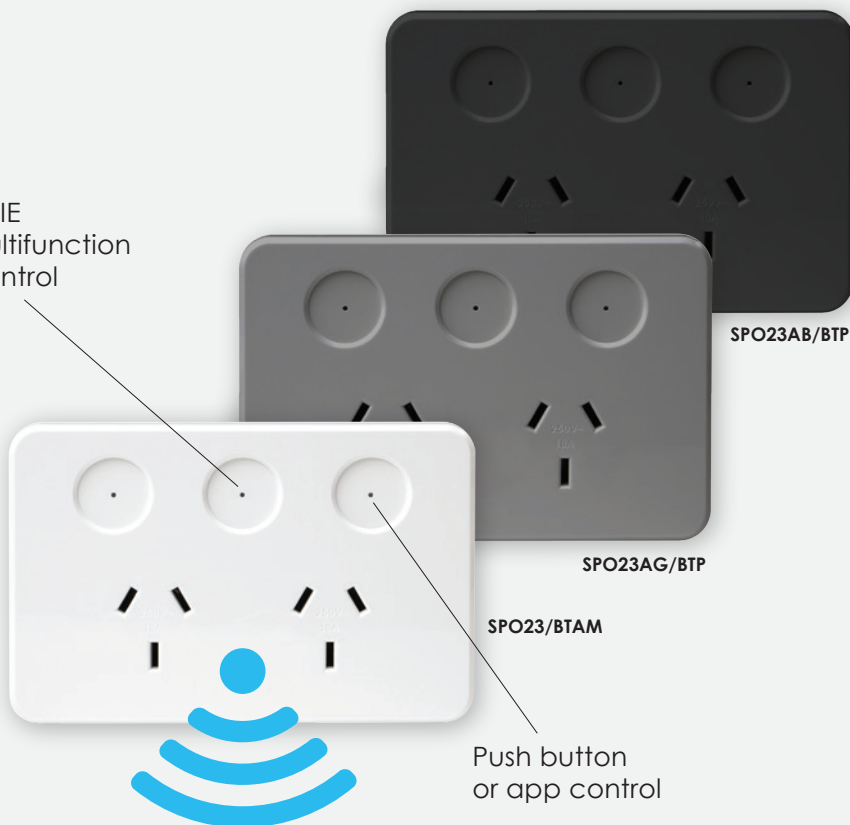

Bluetooth Mesh Technology

CHANGE YOUR COLOUR.





PIXIE AMBIENCE WALL & FACE PLATES

SMART HOME - fixed electrical accessories

Application

Ideal for the home or office, using
PIXIE Smart Home automation controls

Design Specifications

- Easy to install wall plates, with 1,2,3,4,5 or 6 gang configurations
- Stylish face plates to suit the various wall plate combinations, with a choice of white, black or grey colours, complete with a set of mech caps
- Durable polycarbonate construction, low profile design
- PIXIE control mechs shown are ordered separately



Technical Specifications

Model No.	Description
SWAC1GW	1 Gang Face Plate, Gloss White
SWAC2GW	2 Gang Face Plate, Gloss White
SWAC3GW	3 Gang Face Plate, Gloss White
SWAC4GW	4 Gang Face Plate, Gloss White
SWAC5GW	5 Gang Face Plate, Gloss White
SWAC6GW	6 Gang Face Plate, Gloss White
SWAC1SGB	1 Gang Face Plate, Semigloss Black
SWAC2SGB	2 Gang Face Plate, Semigloss Black
SWAC3SGB	3 Gang Face Plate, Semigloss Black
SWAC4SGB	4 Gang Face Plate, Semigloss Black
SWAC5SGB	5 Gang Face Plate, Semigloss Black
SWAC6SGB	6 Gang Face Plate, Semigloss Black
SWABSG	PIXIE Ambience Cap Black (5 Pcs)



Dimensions

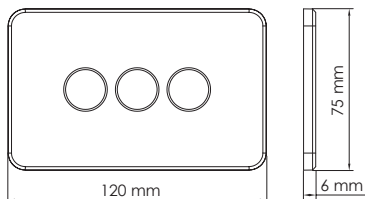

Model No.	Description
SWAC1SGG	1 Gang Face Plate, Semigloss Grey
SWAC2SGG	2 Gang Face Plate, Semigloss Grey
SWAC3SGG	3 Gang Face Plate, Semigloss Grey
SWAC4SGG	4 Gang Face Plate, Semigloss Grey
SWAC5SGG	5 Gang Face Plate, Semigloss Grey
SWAC6SGG	6 Gang Face Plate, Semigloss Grey
SWP1	PIXIE 1 Gang Wall Plate
SWP2	PIXIE 2 Gang Wall Plate
SWP3	PIXIE 3 Gang Wall Plate
SWP4	PIXIE 4 Gang Wall Plate
SWP5	PIXIE 5 Gang Wall Plate
SWP6	PIXIE 6 Gang Wall Plate
SWABSGG	PIXIE Ambience Cap Grey (5 Pcs)

For terms and conditions of catalogue data use, refer to INDEX



**PIXIE AMBIENCE,
CHANGE THE
COLOUR TO MATCH
YOUR STYLE.**





PIXIE AMBIENCE, CHANGE THE COLOUR TO MATCH YOUR STYLE.

The innovative PIXIE AMBIENCE wall & face plates have been designed with the end user and installer in mind, allowing you to change the colour face plate as fashion demands.



Designed with a versatile 1,2,3,4,5 or 6 gang plate combinations and with the use of the innovative range of PIXIE controls, the PIXIE Ambience wall & face plates make the perfect choice for your next electrical fit-out.



PIXIE MASTER

LED STRIP CONTROLLER LT8915DIM/BT

Smart single colour LED strip controller

Application

Home theatre, commercial spaces and decorative feature lighting designs which require smart control

Design Specifications

- Designed for single colour brightness control
- Smooth 0 - 100% dimming
- Input voltage range: 12-24V DC
- 360W maximum power output at 24V
- One channel with two sets of terminals for easy wiring
- Supports momentary switch (bell press) control on any wall plates
- Control button for easy commissioning
- Optional memory function
- Supports both wireless and wired group control



Dimensions

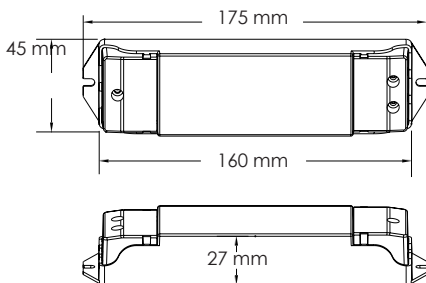

Technical Specifications

Model No.	Description	Input (V)	Power (W)	Dimmable	Body Colour	Dimensions (L x W x H mm)
LT8915DIM/BT	LED STRIP CONTROLLER	12-24 DC	Max 360	Yes	White	175 x 45 x 27

For terms and conditions of catalogue data use, refer to INDEX

Wiring Diagram

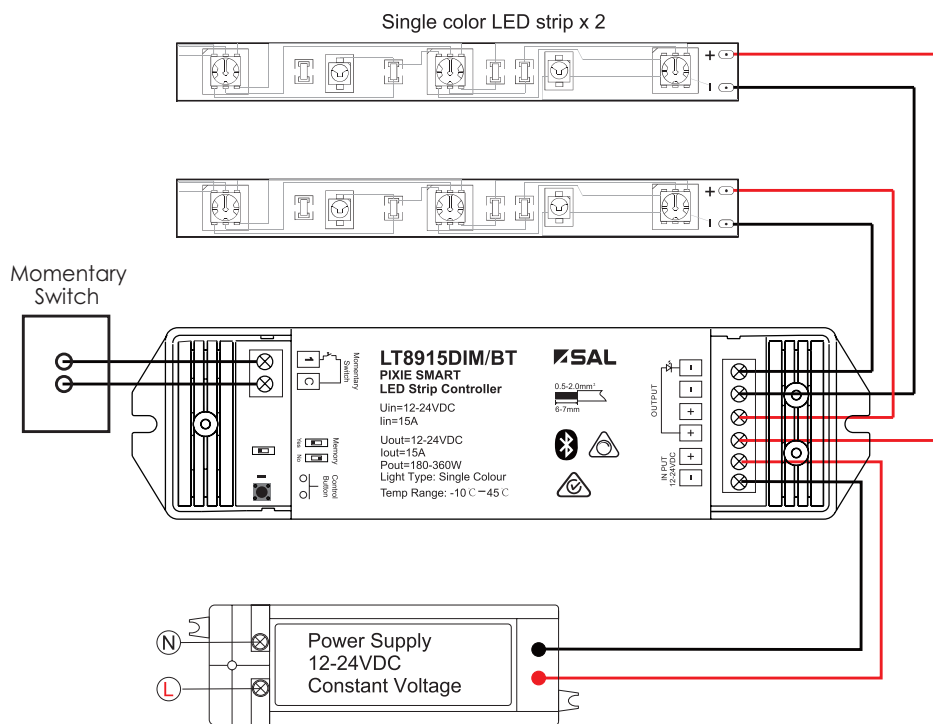

PIXIE MASTER

LED STRIP CONTROLLER LT8915RGB/BT

Smart RGB colour LED strip controller

Application

Home theatre, commercial spaces and decorative feature lighting designs which require smart control

Design Specifications

- Designed for RGB colour and brightness control
- Smooth 0 - 100% dimming
- Input voltage range: 12-24V DC
- Each controller provides three output channels with a maximum current of 6A for each channel
- 432W maximum power output at 24V
- Supports momentary switch (bell press) control on any wall plates
- Control button for easy commissioning
- Four flashing modes
- Optional memory function



Dimensions

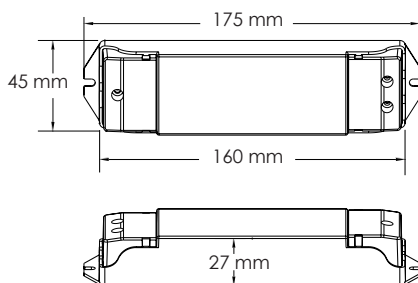

Technical Specifications

Model No.	Description	Input (V)	Power (W)	Dimmable	Body Colour	Dimensions (L x W x H mm)
LT8915RGB/BT	RGB LED STRIP CONTROLLER	12-24 DC	Max 432	Yes	White	175 x 45 x 27

For terms and conditions of catalogue data use, refer to INDEX

Wiring Diagram

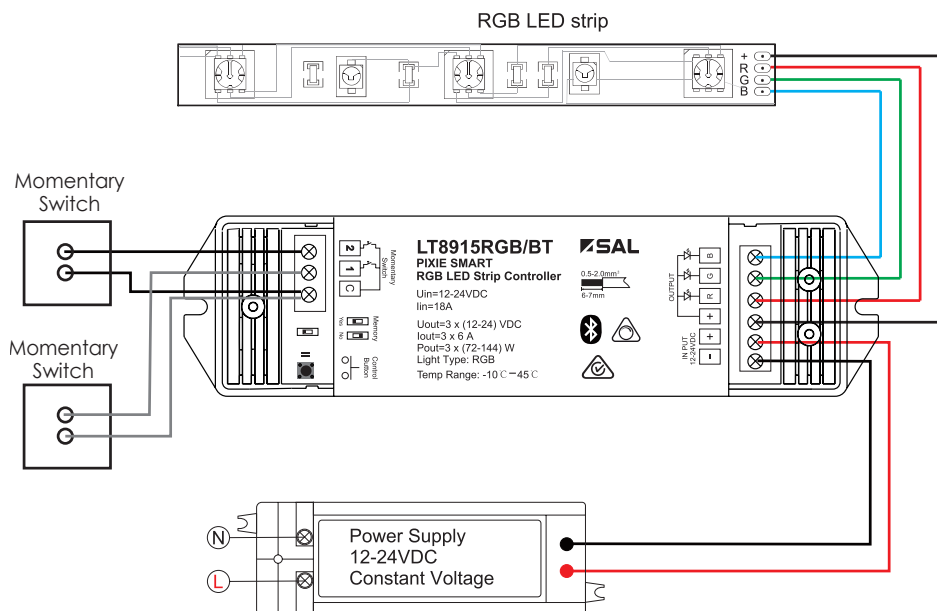

PXIE MASTER

BLIND & SIGNAL CONTROL PC206BS/R/BTAM

Australian approved signal control

Application

Designed for interior blind/curtain control, garage door control or other applications requiring a dry contact signal.



Design Specifications

- Compact design profile
- Double insulation
- Two channel relays to create multiple dry contact signal outputs.
- 6A per channel.
- Dual LED indicators to display the individual channel operating status.
- Interlock functions available for traditional roller motor control.
- Integral CH1 and CH2 control buttons for easy commissioning.

Buttons and terminals

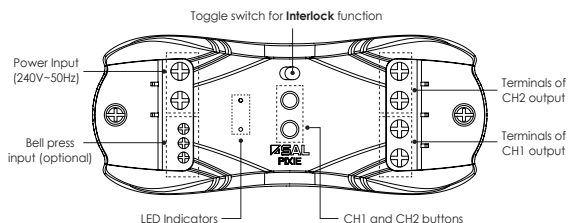

Wiring diagram

(Typical dry contact signal output)

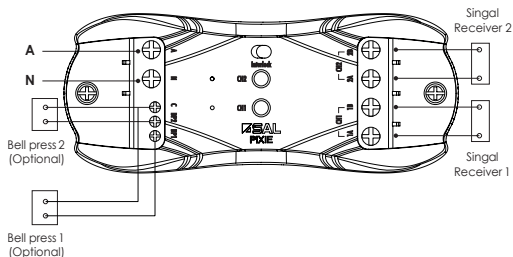

Technical Specifications

Model No.	Description	Input (V)/(Hz)	Output Relay Rating	Mass (g)	Dimensions (L x W x H mm)
PC206BS/R/BTAM	BLIND & SIGNAL CONTROL	240V~50Hz	6A per channel (2 channels)	75	110 x 40 x 26

For terms and conditions of catalogue data use, refer to INDEX



PXIE MASTER

DUAL RELAY CONTROL PC206DR/R/BTAM

Australian approved relay control

Application

Designed for high or low power switch control



Design Specifications

- Compact design profile
- Double insulation
- Two channel relays, switching ON / OFF functions
- 6A per channel
- No minimum load required for low power
- Dual LED indicators to display the individual channel operating status
- Optional Memory function to recall prior operating status, in the event of power outage.
- Integral CH1 and CH2 control buttons for easy commissioning.



Technical Specifications

Model No.	Description	Input (V)/(Hz)	Output Relay Rating	Mass (g)	Dimensions (L x W x H mm)
PC206DR/R/BTAM	DUAL RELAY CONTROL	240V~50Hz	6A per channel (2 channels)	75	110 x 40 x 26

Buttons and terminals

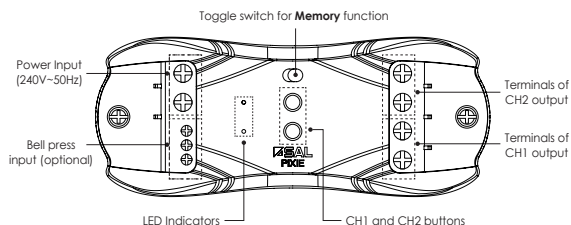

Wiring diagram (Typical application)

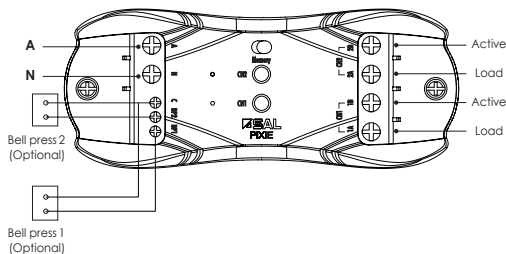

PIXIE SECONDARY

TRANSLATOR CONTROL PC100T/R/BTAS

Australian approved relay control

Application

Designed to accept a dry contact signal and translate the signal to control PIXIE products



Design Specifications

- Compact design profile
- Double insulation
- Accepts voltage-free (dry contact) signals, including Latch and Pulse (momentary) signals.
- Suitable for integration with other systems such as AV, sensors, or security.

Buttons and terminals

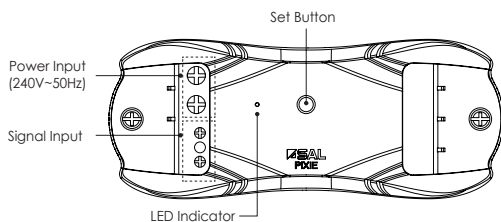

Wiring diagram

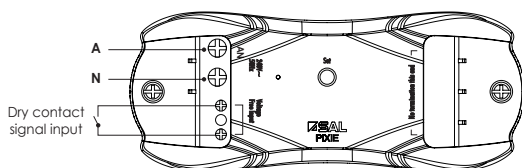

Technical Specifications

Model No.	Description	Input (V)/(Hz)	Standby Power (W)	Mass (g)	Dimensions (L x W x H mm)
PC100T/R/BTAS	TRANSLATOR CONTROL	240V~50Hz	Max. 0.5	58	110 x 40 x 26

For terms and conditions of catalogue data use, refer to INDEX

PIXIE PLUS app control functions include - **set a timer**, no need for cumbersome portable wall mount devices, **schedule function** allows you to dim or switch devices on or off with brightness control and memory, **group function** allows you to group dimmers or switches, **scene function** allows you to set a scene and create an exciting ambience, **sync PIXIE RGB LED strip** to your favourite music.



Device

Manage devices,
individual control



Group

Simultaneously
control a group
of up to 32 x PIXIE
devices



Schedule

Schedule your
lights



Scene

Create preset
lighting scenes



Timer

Countdown
turn-off timer



Sync

PIXIE RGB strips
flash to music

The **PIXIE PLUS**
app is smart
enough to
control multiple
HOME locations,
work or play!

PIXIE PLUS is compatible with
popular voice control devices.



SmartThings



works with the
Google Assistant

**Siri &
Amazon
Alexa.**



PIXIE MASTER

FLEXI SMART FLP12V2M/RGBBT, FLP12V5M/RGBBT

2m or 5m smart lighting RGB LED strip kit
with dimming and colour changing control

Application

Home theatre, bar features, decorative
task illumination demanding smart controls

Design Specifications

- Smart RGB LED strip kit colour and brightness controlled via the included remote, or the PIXIE or PIXIE PLUS apps
- Four different flashing modes
- High performance, stable, even light output, Pre wired for easy installation, plug-in & ready to use and cuttable every 100mm.
- IP44 strip only, driver IP20
- **NOTE:** when cutting LED strips, it is always important to calculate the remaining LED load to reconfirm its compatibility with the existing driver, as driver changes may be required with moderate reduction in loads.
- **NOTE:** heatsink required for warranty and system performance



Technical Specifications

Model No.	Input (V)/(Hz)	Power (W/m)	Colour	Dimming Technique	Beam Angle	Cuttable Length	Dimension (L x W x H mm)	LED Qty.
FLP12V2M/RGBBT	240/50	5.4	RGB	PIXIE	115°	100 mm	2000 x 10 x 3	30 p/m
FLP12V5M/RGBBT	240/50	5.4	RGB	PIXIE	115°	100 mm	5000 x 10 x 3	30 p/m

For terms and conditions of catalogue data use, refer to INDEX



Dimensions

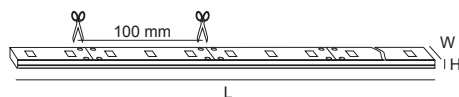

Additional functions when used with the PIXIE or PIXIE PLUS app

- **Timer Function:** Set strips or strip groups to remain on for set period and set a countdown timer (1 min. to 24 hours) until strips or strip groups turn off
- **Schedule Function:** Set strips or strip groups specific time to turn on and off. Required brightness levels can also be selected
- **Group Function:** Group strips together into strip groups and control as one
- **Scene Function:** Set a range of scenarios (scenes) by individual strips or strip groups and activate with one touch

**PXIE MASTER****FLEXI SMART
FLP12V2M SBT, FLP12V5M SBT**

2m or 5m smart lighting, warm white or neutral daylight strip kits

Application

Home theatre, bar features, decorative task illumination demanding smart controls

Design Specifications

- Smart LED strip kit, dimmable via the included remote, or the PIXIE or PIXIE PLUS apps
- Dimming memory function
- High performance, stable, even light output
- Pre-wired for easy installation, plug-in & ready to use, cuttable every 50mm
- IP44 strip only, driver IP20
- **NOTE:** when cutting LED strips, it is always important to calculate the remaining LED load to reconfirm its compatibility with the existing driver, as driver changes may be required with moderate reduction in loads
- **NOTE:** Heatsink required for system integrity and performance

**Technical Specifications**

Model No.	Input (V)/(Hz)	Power (W/m)	Lumen (lm/m)	CCT (K)	Beam Angle	Cuttable Length	Dimension (L x W x H mm)	LED Qty.
FLP12V2M/WW/STB	240/50	6	350	3000	115°	50 mm	2000 x 8 x 2.5	60 p/m
FLP12V2M/NDL/STB	240/50	6	350	5000	115°	50 mm	2000 x 8 x 2.5	60 p/m
FLP12V5M/WW/STB	240/50	6	350	3000	115°	50 mm	5000 x 8 x 2.5	60 p/m
FLP12V5M/NDL/STB	240/50	6	350	5000	115°	50 mm	5000 x 8 x 2.5	60 p/m

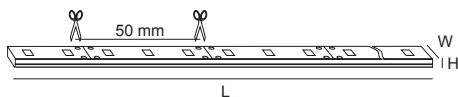
**Dimensions****Additional functions when used with the PIXIE or PIXIE PLUS app**

- **Timer Function:** Set strips or strip groups to remain on for set period and set a countdown timer (1 min. to 24 hours) until strips or strip groups turn off
- **Schedule Function:** Set strips or strip groups specific time to turn on and off. Required brightness levels can also be selected
- **Group Function:** Group strips together into strip groups and control as one
- **Scene Function:** Set a range of scenarios (scenes) by individual strips or strip groups and activate with one touch

Terms and conditions of catalogue data use:

1. Copyright SAL National Pty Ltd 2021
2. Compliances, installation and operations reflect product use in the region of Australia (and New Zealand for products listed on www.sal.co.nz).
3. All data and images contained within remain the property of SAL National Pty Ltd, or as acknowledged by the provider.
4. Trademarks shown remain the property of the relevant brand, company or third party. SAL, PIXIE PLUS and PIXIE are trademarks of SAL National.
5. Images, tones and finishes shown are for guidance only and may vary from the actual product, which if critical to the installation must be confirmed at order placement.
6. Due to continued product specification, standards and information updates, product data sourced from this document shall not form part of any contract and or technical performance guarantee unless expressly confirmed in writing by SAL at the time of order.
7. For INTERIOR products, the designated IP rating is "from below the ceiling" unless otherwise specified.
8. SAL products are designed in accordance with all relevant and mandatory International and Australian Standards, which require installation by a qualified installer in accordance AS/NZS3000 and the manufacturers installation instructions, which require regular cleaning and maintenance of the equipment.
9. Product sales arising from this publication are sold in accordance with SAL standard terms and conditions of sale, available via www.sal.net.au and www.sal.co.nz where relevant.
10. Due to continued product and regulative developments, validation of ANY sustainable rebate program product accreditation, must be confirmed prior to purchase via the relevant authority's web site.

